

# ZAPPLIGHT® MOSQUITO KILLING LED LIGHT BULB

## Owners Manual IMPORTANT SAFETY INSTRUCTIONS

READ THE ENTIRE PRODUCT  
LABEL AND OWNERS MANUAL  
BEFORE USING

### ELECTRIC SHOCK RISK – ONLY FOR DRY LOCATIONS

Thank you for choosing the *Zaplight® Mosquito Killing LED Light Bulb*. Please read the instruction manual carefully to ensure use of this product complies with all safety regulations.

The *Zaplight® Mosquito Killing LED Light Bulb* is a dual-purpose bug zapper and LED light compatible with most standard electrical sockets. The unit attracts a wide range of flying insects and a 1,400V zapping grid which kills them on contact. The zapper utilizes LED and blue UV light to draw in flying insects within an 855 square foot area. The bright 600 lumen LED light is suitable for illuminating surrounding areas.

*This device complies with part 15 of the FCC Rules. Operation is subject to the following two conditions: (1) This device may not cause harmful interference, and (2) this device must accept any interference received, including interference that may cause undesired operation. Changes or modifications not expressly approved by the manufacturer could void the user's authority to operate the equipment.*

*NOTE: This equipment has been tested and found to comply with the limits for a Class B digital device, pursuant to part 15 of the FCC Rules. These limits are designed to provide reasonable protection against harmful interference in a residential installation. This equipment generates, uses and can radiate radio frequency energy and, if not installed and used in accordance with the instructions, may cause harmful interference to radio communications. However, there is no guarantee that interference will not occur in a particular installation. If this equipment does cause harmful interference to radio or television reception, which can be determined by turning the equipment off and on, the user is encouraged to try to correct the interference by one or more of the following measures: —Reorient or relocate the receiving antenna. —Increase the separation between the*

*equipment and receiver. —Connect the equipment to an outlet on a circuit different from that to which the receiver is connected. —Consult the dealer or an experienced radio/TV technician for help.*

### INSTALLATION:

1. Turn the light switch **OFF** on the fixture you wish to install the product.
2. Remove the existing bulb.
3. Screw the product completely into the socket clockwise.

### OPERATION:

The *Zaplight® Mosquito Killing LED Light Bulb* can be used with most electrical sockets and is operated using the standard light switch already operating your light fixture. Additional equipment is not required.

- The product has **TWO** operating modes –
1. Blue UV and bug-zapping with LED light
  2. Blue UV and bug-zapping only

- ①. By flipping the switch **ON**, the bulb will operate in bug-zapping mode with both the blue UV light and LED light.
- ②. By flipping the light switch **OFF** then **ON** again within 1 second, the bulb will operate in bug-zapping mode with the blue UV light.

**Note:** *This switch over function from mode 1 to mode 2 is only valid for 1 second after the switch is flipped from OFF to ON.*

To turn the unit **OFF**, flip the electrical switch to the **OFF** position. When all lighting functions are off, you know the bug-zapping mode is off as well.

### Product Information:

- Voltage: 120V
- Grid Voltage: 1400V
- Luminous Flux: 600lm
- Lighting Power: 9W (=65W Standard)
- Frequency: 50-60Hz
- Protection Area: ~855 sq. ft.

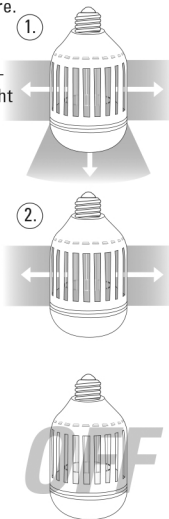

**CAUTION – High Voltage.** Keep out of reach of children.  
**CAUTION – High Voltage,** disconnect before servicing.  
**CAUTION –** To reduce the risk of fire, remove insects frequently.  
**CAUTION –** Collected insects may be a fire hazard. Clean dead insects from the unit with the provided brush frequently.  
**WARNING –** Skin or eye damage may result from directly viewing the light produced by the lamp in this apparatus. Always disconnect power before relamping or servicing.  
**CAUTION – ELECTRICAL SHOCK HAZARD. DO NOT DIRECT WATER, CLEANING SPRAY, OR ANY OTHER LIQUID AT UNIT WHILE IN OPERATION.**  
**CAUTION –** Do not allow children to insert bulb into socket.  
**CAUTION –** Do not stick foreign objects, metal objects or fingers into the unit.  
**CAUTION –** Do not tamper with or modify unit.  
**CAUTION –** Do not clean unit while in electrical socket  
**CAUTION –** Remove unit from electrical socket before cleaning.  
**CAUTION –** Do not remove bulb while hot.  
**CAUTION –** Before cleaning, allow bulb to sit for at least 45 minutes to release charge from electric grid.  
**CAUTION –** Use only the provided brush for cleaning unit.  
**CAUTION –** Do not clean or spray the unit with water, cleaning spray, or any other liquid.  
**CAUTION –** Do not submerge unit in water or any liquid.  
**CAUTION –** Keep out of contact with flammable items such as paper or clothing.  
**CAUTION –** Do not use flammable liquids around unit.  
**CAUTION –** Product is not compatible with HID lamps such as the lighting apparatus, induction lamp, halogen lamp, which have the mechanism and the electric circuit to adjust light.  
**CAUTION –** Do not use in light with dimmable switch  
**CAUTION –** Do not use if unit or electric grid is damaged or bent.  
**CAUTION –** Use in a fixture installed by a qualified electrician.  
**CAUTION –** Do not use in emergency exit fixtures.

**ELECTRIC SHOCK RISK – DO NOT DIRECTLY EXPOSE TO WATER OR LIQUIDS**



Distributed By:  
**PIC® Corporation**  
1101-1107 W Elizabeth Ave.  
Linden, NJ 07036  
1-800-799-7302

STOCK#IKB-ZAPP  
MADE IN CHINA  
EPA Est. No. 92299-CHN-1  
PATENT PENDING  
v121917b

